

Connecto® I Shallow channel – Outside width 130 mm – dark grey

Code: CAB133A

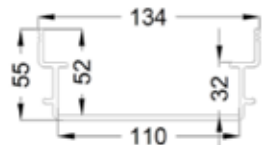

EN1433

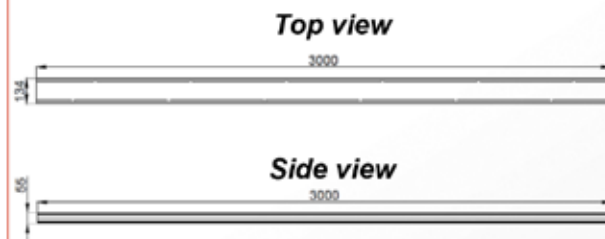

FUNCTION:

The drainage channel is designed to drain run-off water. In accordance with EN1433 standard and the  marking, it can be used in private areas for all building applications, the environment of home, pedestrian areas, private car parks or car parking decks in class A15 or B125.

DESCRIPTION:

This channel body is injected in light grey polypropylene with male/female interlocking system. Most of Nicoll gratings 128 mm wide (PVC, PP, Polyamide, galvanized steel or stainless steel) are suitable with this channel.

ACCESSORIES:

The network connection can be realized thanks to the following PVC accessories:

- end cap/end or lateral outlet Ø 40/50: NAHJ13A
- vertical outlet Ø 100 or 110: STCAB13 or SVCAB13
- junction: JCAB13
- locking system with galvanized screw: FIXCAB13

CHARACTERISTICS:

Effective width: 110 mm
 Effective depth: 32 mm
 Hydraulic section: 35 cm²
 Weight: 3,4 kg

STCAB13
SVCAB13

NAHJ13A

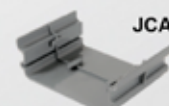

JCAB13



FIXCAB13

IMPLEMENTATION:

1. See the scheme opposite for class A15
2. See the scheme opposite for class B125

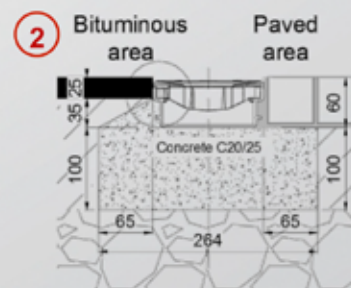
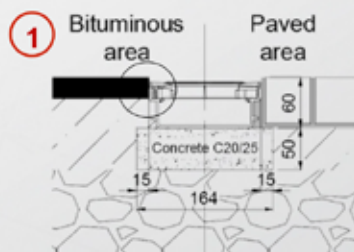
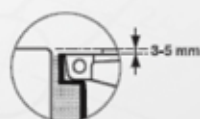

QUALITY - ENVIRONMENT:

ISO 9001
 ISO 14001
 ISO 50001
 BUREAU VERITAS
 Certification



DATE: August 2015